

## SCHEDULE OF MATERIALS    'Florette' by Anna Walker

### 1. Foliage Studies

X 11 paintings

The largest measures 56cm x 33cm



## 2. Building Studies

X 6 paintings

Approximately 37cm height x 56cm width



### 3. Mae Studies

X 10 paintings

Largest piece A4





#### 4. Reference

✓ X 6 sheets

A3 and A2





## 5. Landscape Studies

X 2 paintings

Approximately 32cm x 21cm



## 6. Storyboard dummies

X 7





## 7. Parent Studies

X 3 paintings

Approximately 45cm x 30cm and two smaller paintings



## 8. Pencil roughs

X 2 drawings ✓

Approximately A3

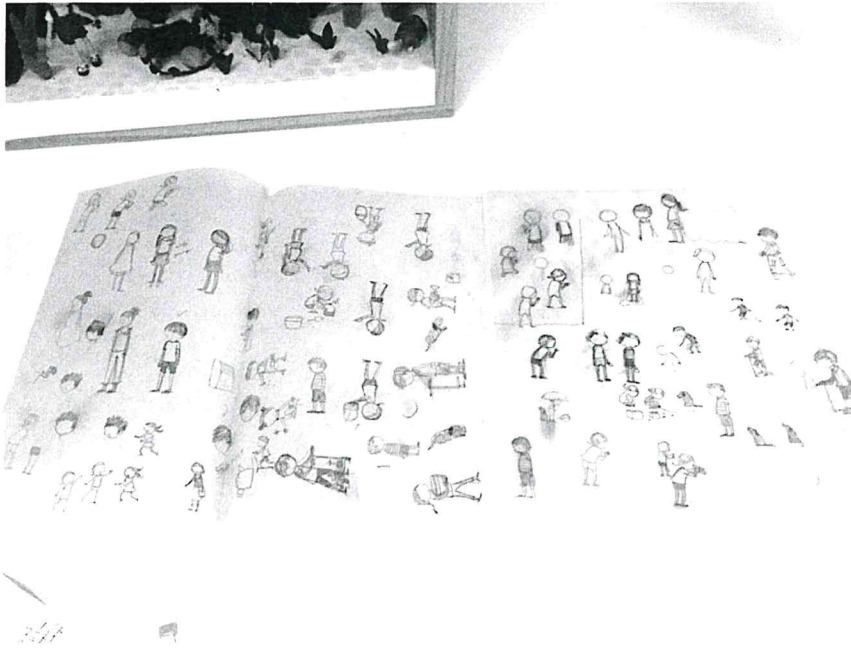

## 9. Pen and printed roughs

X 6 roughs Approximately A3 and A4

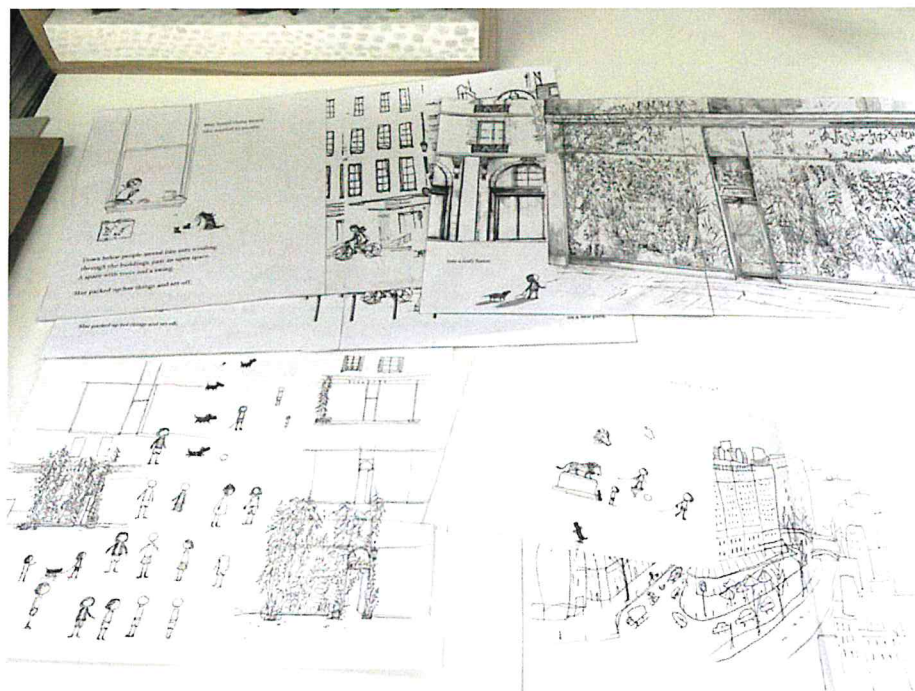



10. Endpapers (not used in final)

✓  
X 1 rough and x4 paintings 34cm x 57cm









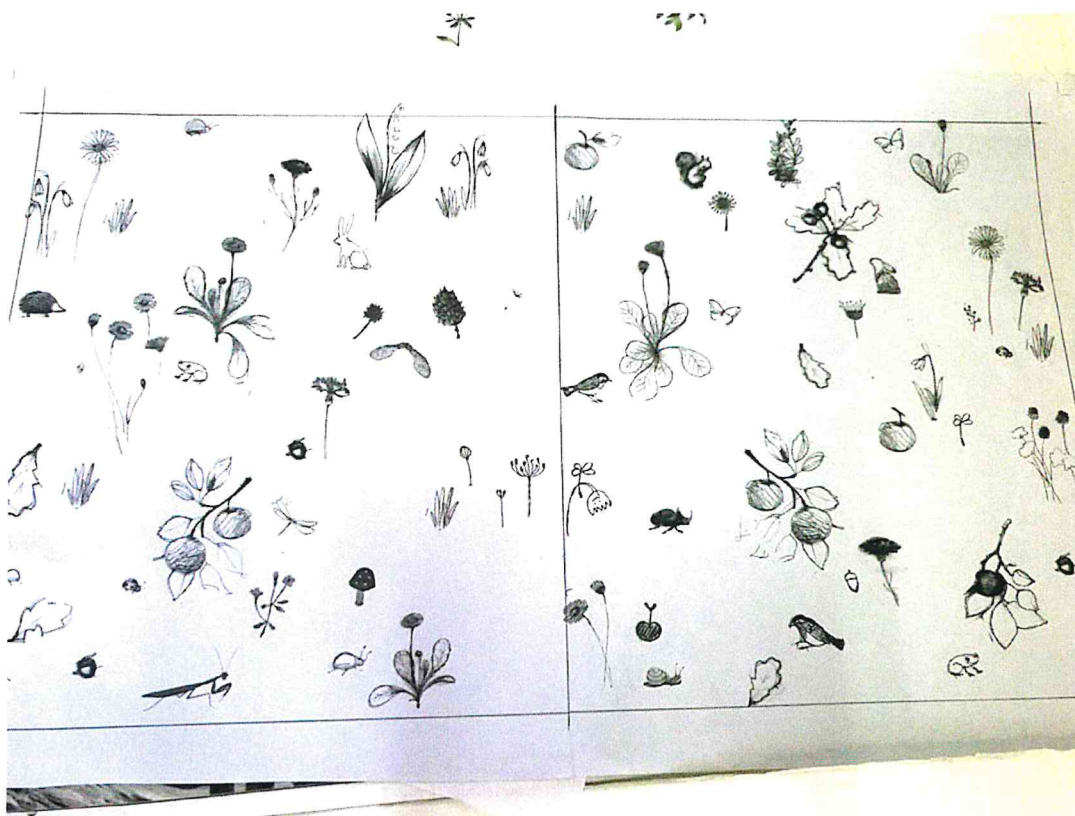

# 11. Dog studies

X 3 paintings Approximately 20cm x 20cm

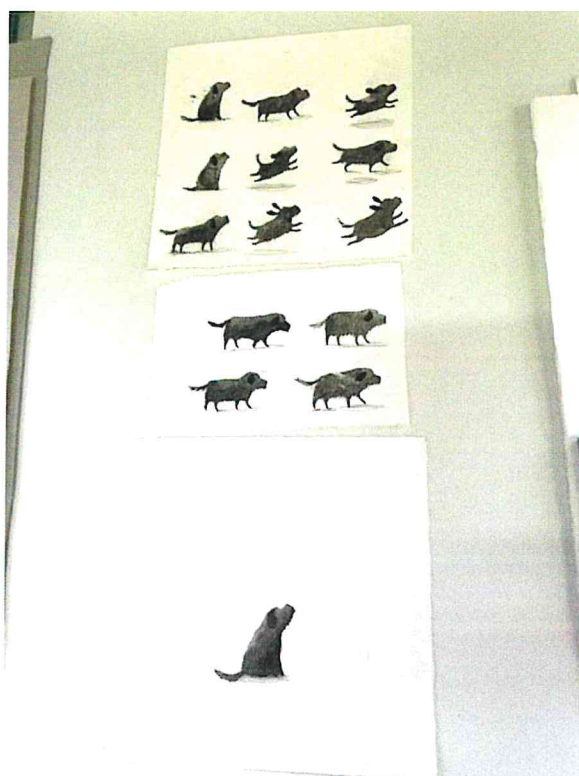



## 12. Fabric

Print using endpaper pattern on fabric: 2 metre x 2 metre (folded in photo below)









### 13. Diorama

375mm height

190mm depth

490mm width







#### 14. Original Paintings used in book

There are approximately 159 paintings of various sizes used in creating the final images.

The photos below show a sample of them.







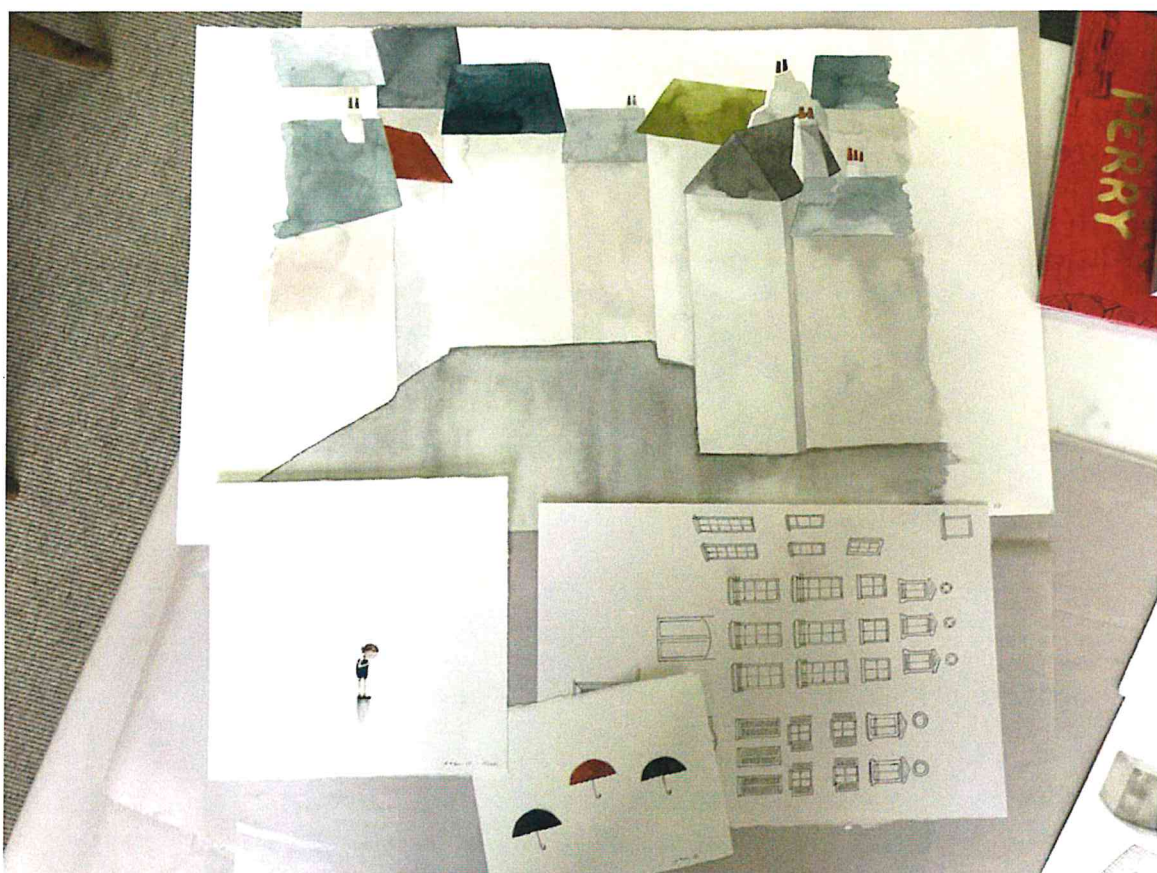



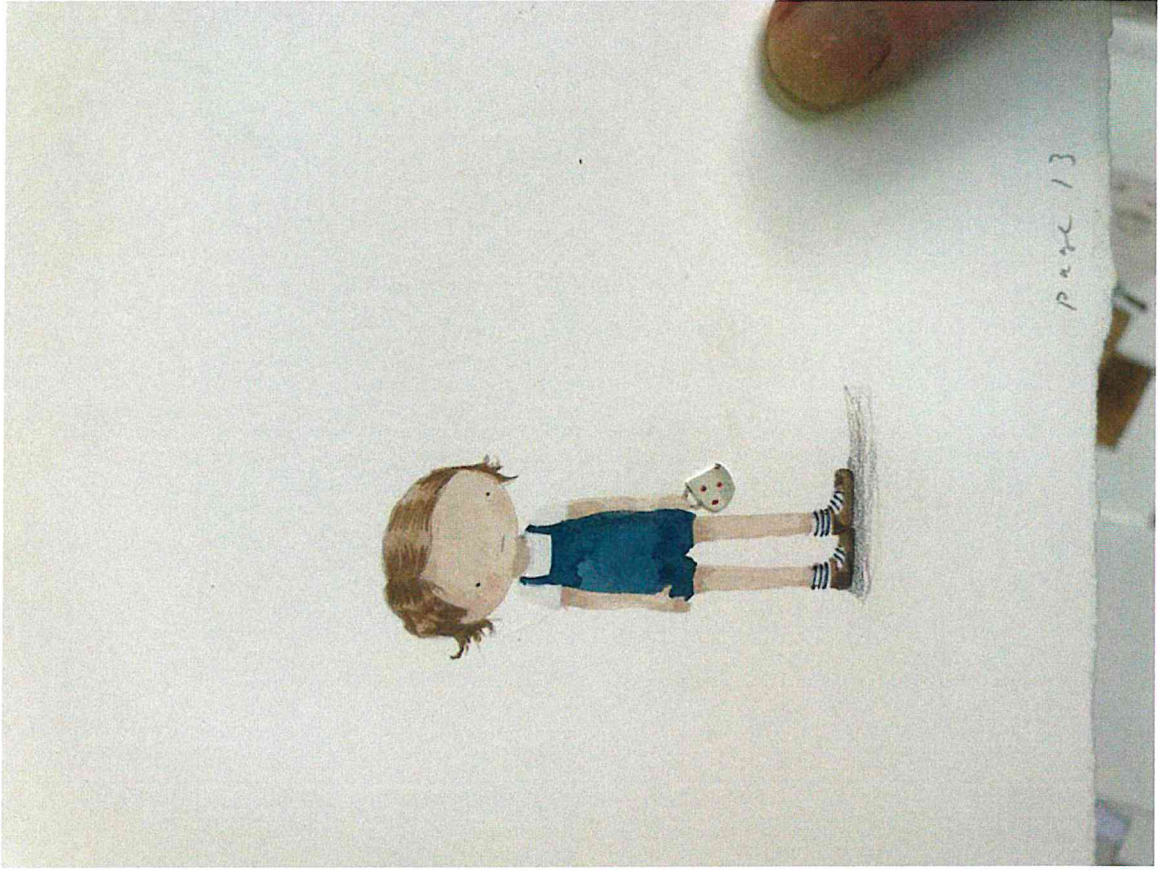





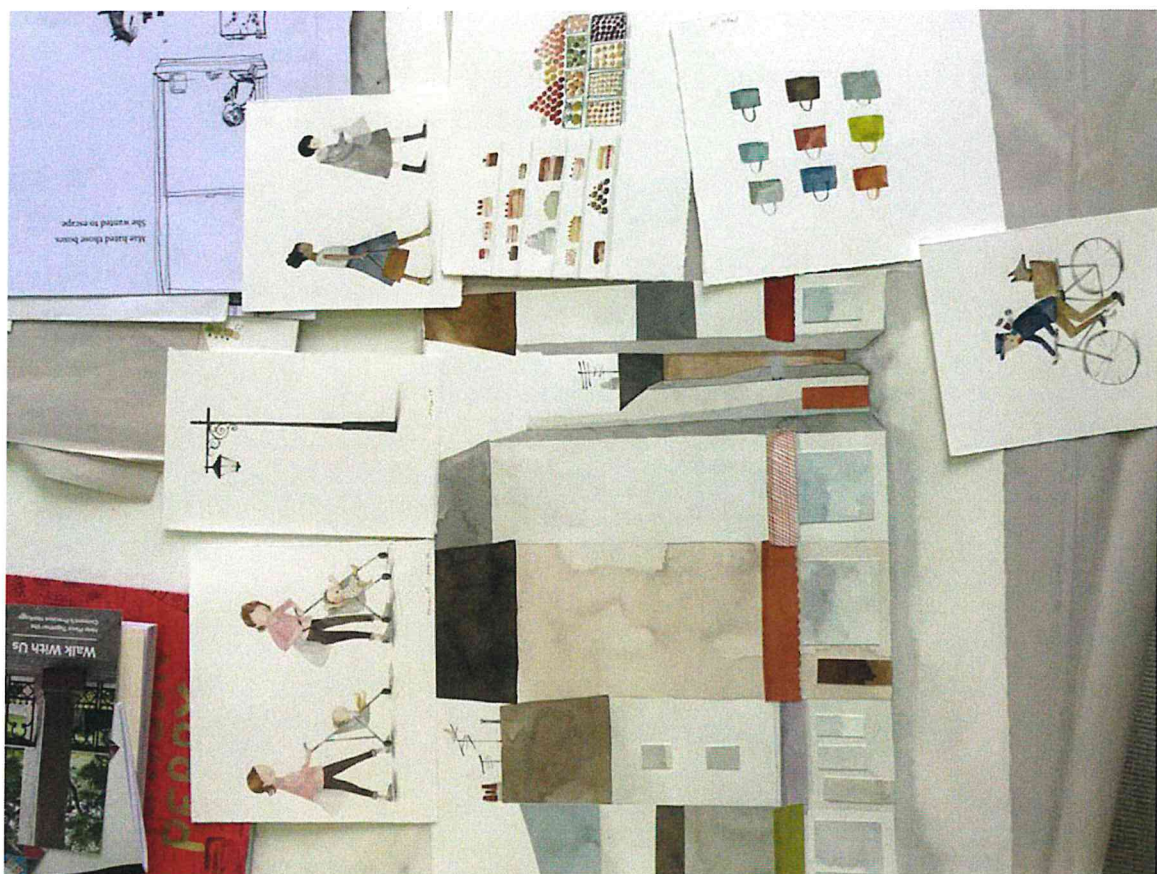









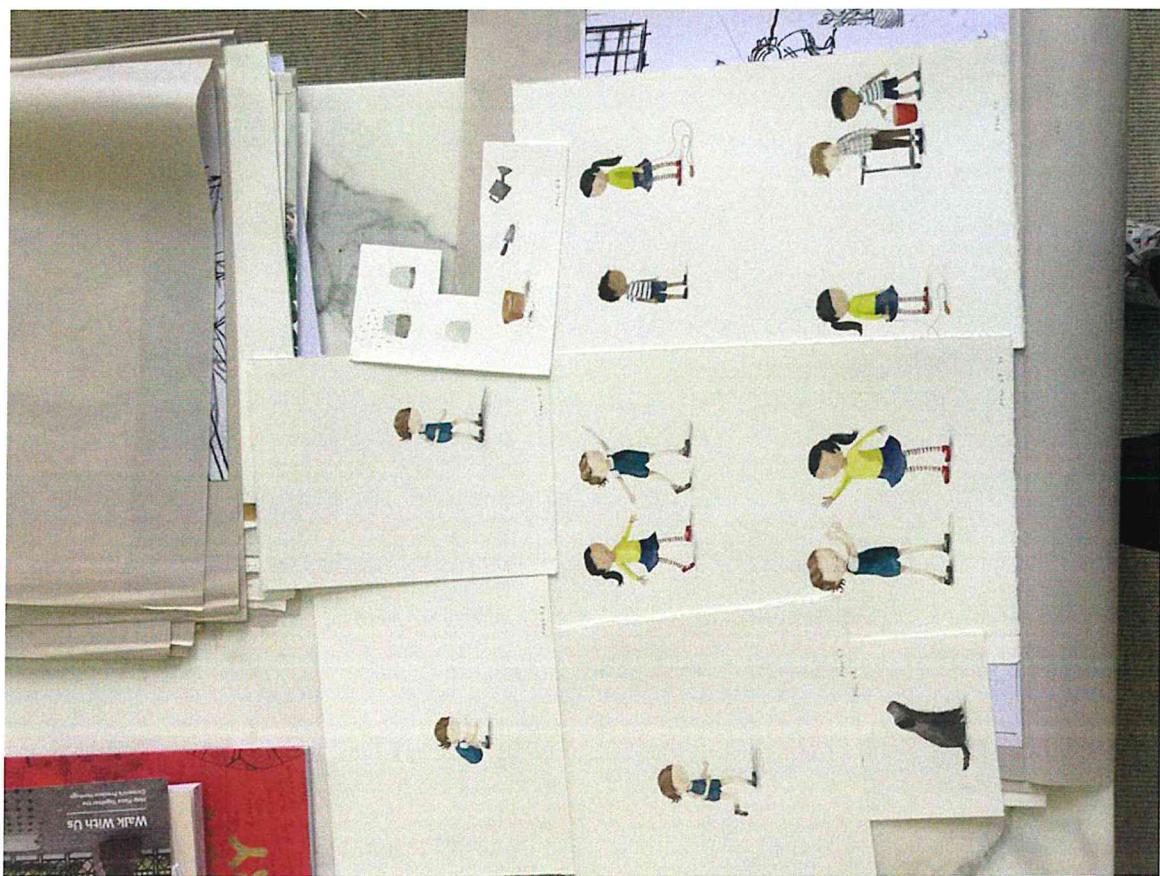





page 24

she weaved her way  
through the empty chairs,

page 24



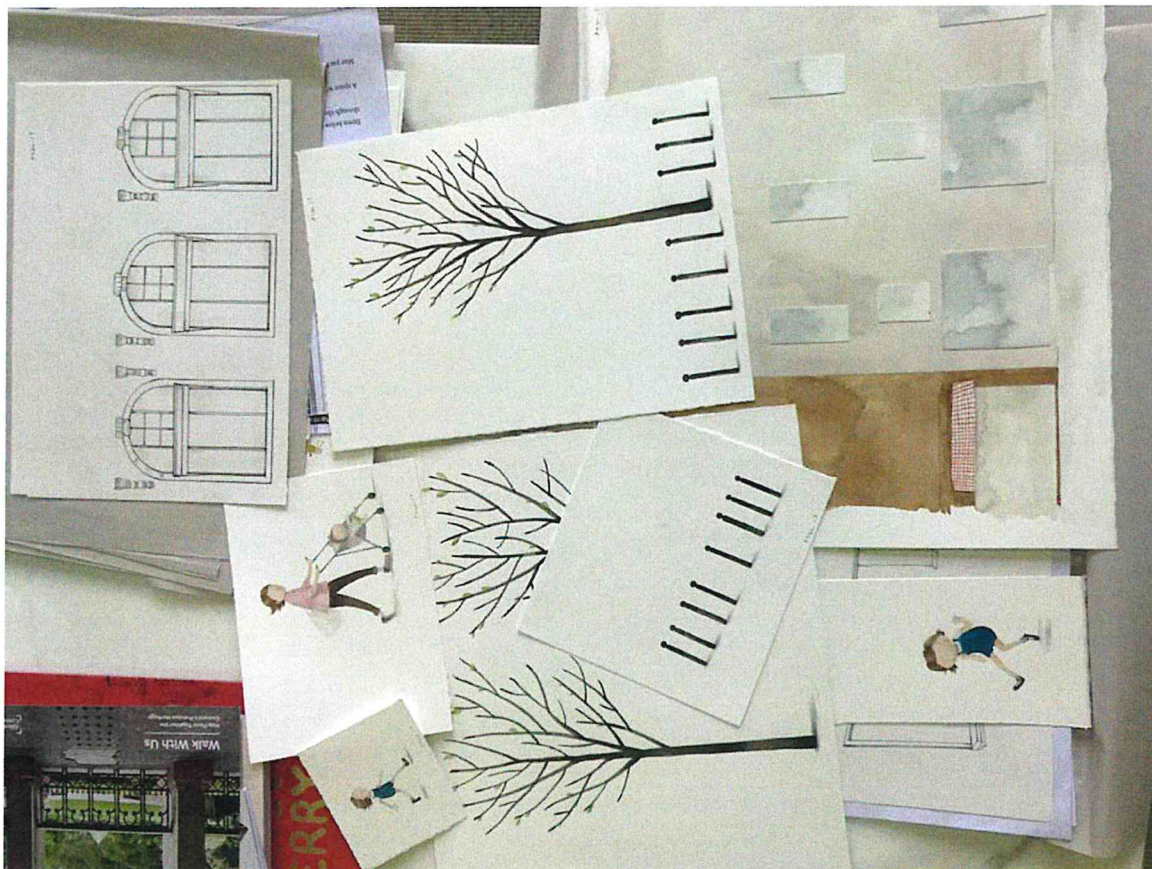



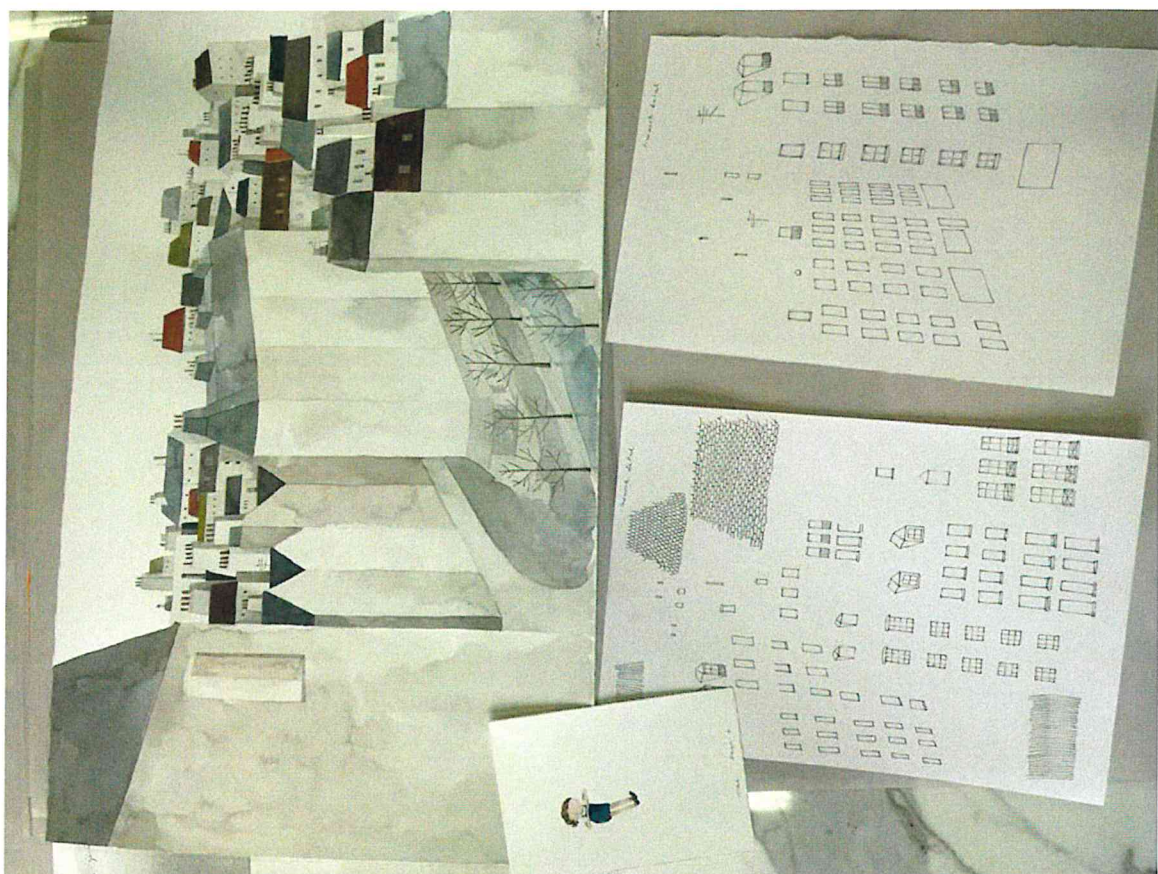



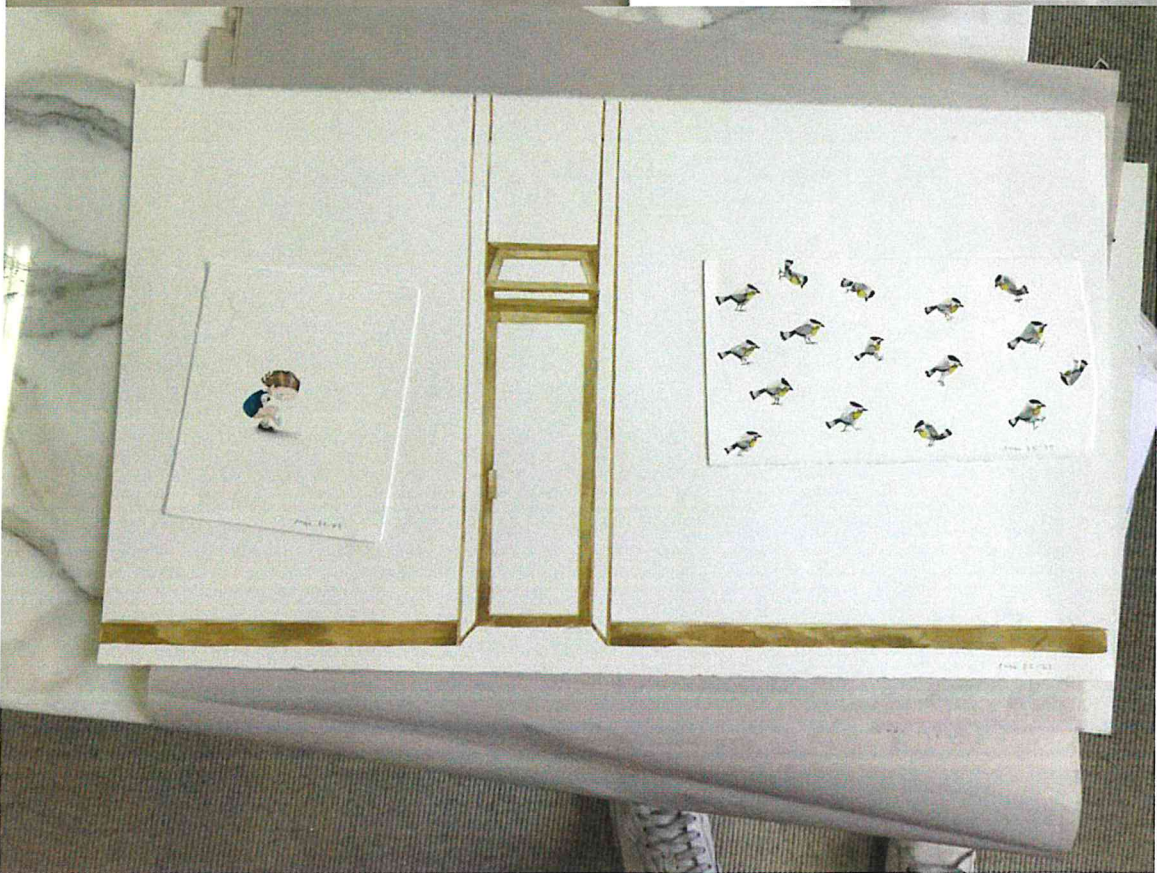



### 15. Cardboard garden creatures

Frog, approximately 18cm x 18cm

I have a few other cardboard bugs to send too but they are hiding at the moment!



## 16. Archival Prints of Illustrations from 'Florette' including Endpapers and Cover

X 35 prints

Internal pages 275mm height x 480mm width

Cover 280mm height x 530mm width

Title page 275mm height x 240mm width

